

London 50

TOP & SPLASHBACK SPECIFICATION



Product Features

Material of Splashback	Cherry Pie®
Splashback Colours	Splashback colour matches benchtop colour
Splashback width	Splashback width is equal to benchtop width
Notes:	Splashback installation is optional

Top Dimensions (mm)	(A)	(B)	(C)
London 50 - 750	750	510	60
London 50 - 900	900	510	60
London 50 - 1200	1200	510	60
London 50 - 1500	1500	510	60
London 50 - 1800	1800	510	60

Cherry Pie® dimensions

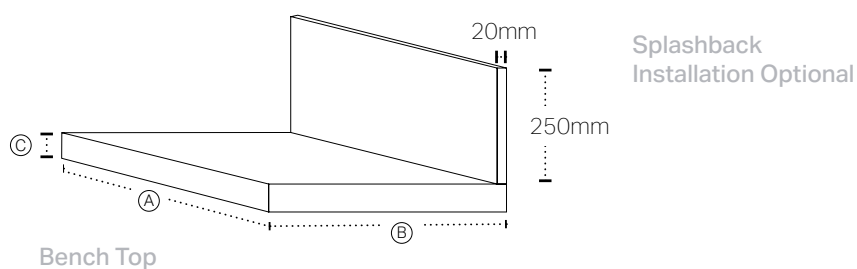

IMPORTANT NOTE: Throughout this guide, dimensions may vary by ± 5 mm. Please read the installation manual for detailed information on installing the product. St. Michel pursues a policy of continuing improvement in design and manufacturing of its products. The right is therefore reserved to vary specifications without notice.



phone (09) 837 4276 email info@stmichel.co.nz stmichel.co.nz